

PH71

Soft Serve Freezer

Single Flavor, Pump

Features

Offer all the popular soft serve variations from low- to non-fat ice creams or yogurt.

Heat Treatment System

Provides a daily heating and cooling cycle to safely maintain dairy products up to two weeks before a complete disassembly and cleaning is required.

Freezing Cylinder

One, 3.4 quart (3.2 liter).

Mix Hopper

One, 20 quart (18.9 liter). Refrigerated to maintain mix below 41°F (5°C) in Auto and Standby modes. Air/mix pump delivers the precise amount of air and mix to the freezing cylinder.

Indicator Lights

Mix Low light alerts the operator to add mix. When the Mix Out light flashes, the unit automatically goes into Standby mode to prevent damage.

Electronic Controls

Viscosity is continually measured to serve consistent quality soft serve. The LCD (Liquid Crystal Display) readout will identify temperatures in the hopper or freezing cylinder at any point of operation. History of temperatures and times during the last 13 heat cycles may be viewed.

Standby

During long no-use periods, the standby feature maintains safe product temperatures in the mix hopper and freezing cylinder.

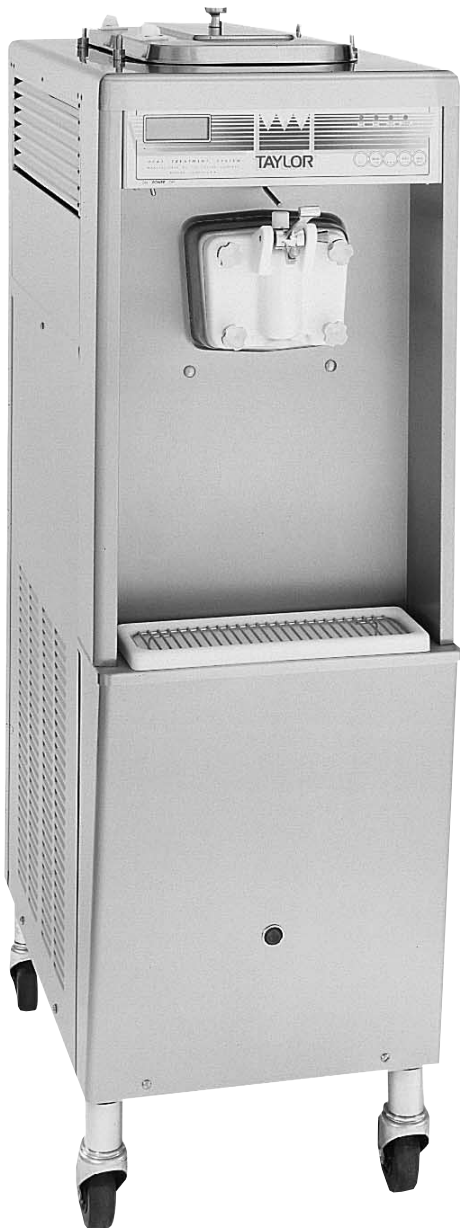

In-Hopper Air/Mix Pump



Standard 6



LISTED
SA2650



Selected 50
Hz. Models

PH71 Soft Serve Freezer

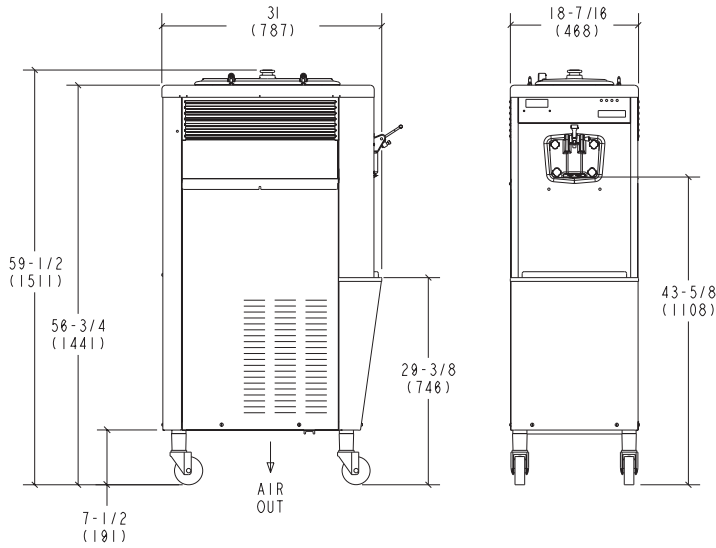

NOTE: FIGURES IN PARENTHESES INDICATE MILLIMETERS.

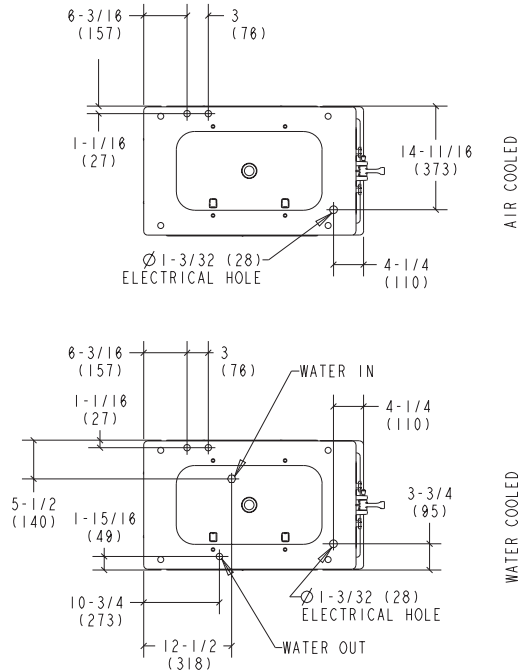

Weights	lbs.	kgs.
Net	530	240.4
Crated	600	272.2
	cu. ft.	cu. m.
Volume	36.1	1.02

Dimensions	in.	mm.
Width	18-7/16	468
Depth	31	787
Height	58-7/8	1495
Floor Clearance	7-1/2	191

*Mounted on standard casters

Electrical	Maximum Fuse Size	Minimum Circuit Ampacity	Poles (P) Wires (W)
208-230/60/1 Air	40	29	2P 3W
208-230/60/1 Water	40	26	2P 3W
208-230/60/3 Air	25	21	3P 4W
208-230/60/3 Water	25	19	3P 4W
220-240/50/1 Air	40	26	2P 3W
220-240/380-415/50/3 Air	20	14	4P 5W

This unit may be manufactured in other electrical characteristics. Refer to the local Taylor Distributor for availability. (For exact electrical information, always refer to the data label of the unit.)

Bidding Specs

Electrical: Volt _____ Hz _____ ph _____
 Neutral: Yes No | Cooling: Air Water NA

Options: _____

Specifications

Electrical

One dedicated electrical connection is required. See the Electrical chart for the proper electrical requirements. Manufactured to be permanently connected. Consult your local Taylor distributor for cord & receptacle specifications as local codes allow.

Beater Motor

One, 1.5 HP

Refrigeration System

One, 9,500 BTU/hr. R404A. (BTUs may vary depending on compressor used.)

Air Cooled

Minimum 3" (7.6 cm) around all sides. Install the deflector provided to prevent recirculation of warm air. Minimum air clearances must be met to assure adequate air flow for optimum performance.

Water Cooled

Water inlet and drain connections under side of base 3/8" FPT.

Options

- Cone Dispenser
- Draw Valve Lock
- Faucet
- Hopper Locks
- Magnetic Self Service Decal and Flavor Pads
- Panel Spinner
- Sneeze Guard
- Syrup Rail Kit (side mount)

Continuing research results in steady improvements; therefore, these specifications are subject to change without notice.



Taylor Company,
 a division of Carrier Commercial Refrigeration, Inc.
 Rockton, Illinois 61072
 815-624-8333 800-255-0626 Fax 815-624-8000
 www.taylor-company.com

Printed in U.S.A.

053622-ADV 07/03